

MOMENTUM® Flush Valve Rebuild Kit

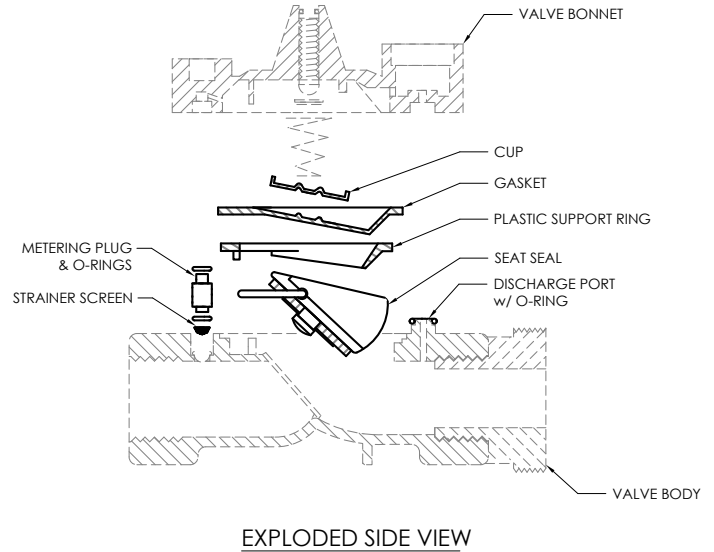

Part No. 100325

► **Description**

A complete internal rebuild kit for the 1" MOMENTUM® Flush Valve. This kit will rebuild all I-CON series 3700 and 3800 model MOMENTUM® Flush Valves. Kit includes the valve's seat seal, a 3801 model flush valve support ring (marked with "38" on the left & "SR" on the right side of a rib found on the arc of the ring), a 3711 model flush valve support ring, pressure separation gasket, metering plug and o-rings, strainer screen, discharge port o-ring and stand cup allowing for the rebuilt valve to meet the standards of a new MOMENTUM® Flush Valve.

Specifications

- (1) Cup
- (1) Gasket
- (1) 3801 Model Plastic Support Ring
Marked with "38" & "SR" on each side of rib on arc.
- (1) 3711 Model Plastic Support Ring
- (1) Seat Seal
- (2) Metering Plug O-Rings
- (1) Metering Plug
- (1) Strainer Screen
- (1) Discharge Port O-Ring

► **Accessories**

See Accessories Section of the I-CON catalog or contact our Customer Service Team for details.



WARNING: Cancer and Reproductive Harm - www.P65Warnings.ca.gov

This space is for Architect/Engineer approval

The information contained in this document is subject to change without notice.